

# AVer CP3 Series

## Spark Curiosity

The all-in-one solution for classrooms!



### Essential tools to enhance learning

Make notes clearly visible with responsive and precise writing on the feature-rich whiteboard. Use a different color for each step in an equation with a rainbow palette of colors available. Encourage participation by having multiple students work to solve a problem at the same time.



### Share screens, share ideas

Built-in native screen share technology lets students lead the discussion with the ability to share their work, and help each other understand. Explore new ways to learn and boost collaboration.

### Futureproof technology

Keep up with constantly changing technology with the upgradeable built-in Android Module. The low power and high-performance computing provide an optimal experience for any application.

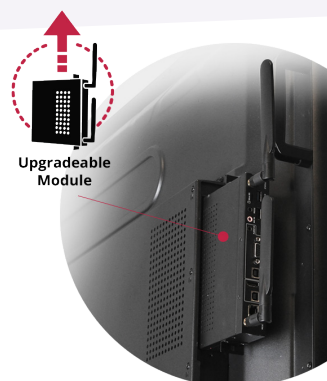



## Transform lessons in new ways

Take learning further with wireless AVer document camera integration. Teach from a student's desk to show a live chemistry experiment, or share a student's art project with the entire class. Put creative minds to work and inspire students to show their work.

## Experience simplicity and security

Built for the classroom with Android's most advanced operating system to easily navigate through different apps, and lesson plans. Every interactive flat panel also comes with screen and app lock to promote safe learning, and make any app or the entire screen password protected.

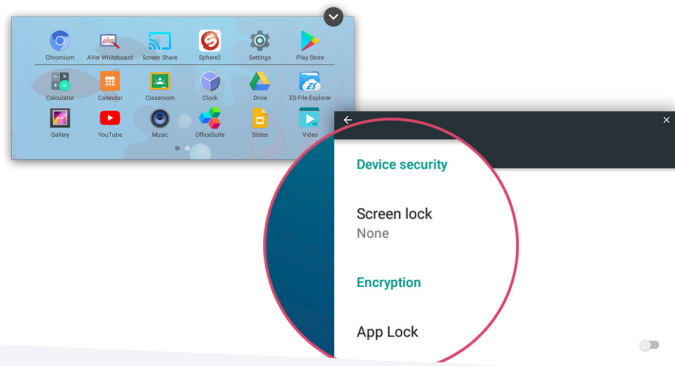

## Save time and stay organized

Make more time for learning with the only interactive flat panel to provide a class schedule, and digital bulletin board. Customize the home screen, and let students see what fun activities are planned for class.

## Reliable customer care included

Every interactive flat panel comes standard with AVer's best-in-class service and warranty program. Advance replacement and onsite repair mean no classroom disruptions due to technology. Training and services are also provided to ensure smooth deployment, and an exceptional product experience.





Screen Share



Upgradeable Module



Wireless AVer Doc Cam Integration



Screen & App Lock



Split-Screen Multitasking



Built-in Modern Whiteboard



Digital Bulletin Board



5-Yr Warranty With Onsite Repair

## Specifications

Model	CP3-65i	CP3-75i	CP3-86i
SKU	IFPCP365i	IFPCP375i	IFPCP386i

### Display Panel

Active Screen Size (inches)	65"	75"	86"
Display Backlight	LED	LED	LED
Display Ratio	Landscape 16:9	Landscape 16:9	Landscape 16:9
Resolution	UHD3840 x 2160	UHD3840 x 2160	UHD3840 x 2160
LCD Brightness	450cd/m2	450cd/m2	400cd/m2
Contrast Ratio (typical)	1200:1	1200:1	1200:1
Response Time (typical)	≤6ms	≤8ms	≤8ms
Viewing Angle	178°	178°	178°
Power Consumption	180W (system boot up)	180W (system boot up)	180W (system boot up)
Touch Surface Material	Tempered Glass 4mm Level 7 MoHS	Tempered Glass 4mm Level 7 MoHS	Tempered Glass 4mm Level 7 MoHS
Touch Surface Technology	Anti-Glare Glass	Anti-Glare Glass	Anti-Glare Glass
Transparency	>88%	>88%	>88%
Touch Sensor	Infrared	Infrared	Infrared
Touch Points	20 points (Win/Android); Multi-touch gesture on MAC 1 point for Chrome	20 points (Win/Android); Multi-touch gesture on MAC 1 point for Chrome	20 points (Win/Android); Multi-touch gesture on MAC 1 point for Chrome
Touch Screen Writing Tools	Writing Pen or Finger	Writing Pen or Finger	Writing Pen or Finger
Positioning Accuracy	±1mm (90% area)	±1mm (90% area)	±1mm (90% area)
Communication Interface	USB-B x 4 (1x front, 3x back) / Type-C x1	USB-B x 4 (1x front, 3x back) / Type-C x1	USB-B x 4 (1x front, 3x back) / Type-C x1
Life Time	Up to 50,000hrs	Up to 50,000hrs	Up to 50,000hrs
Frame Material	Aluminum	Aluminum	Aluminum
Scalar	MSD6A828	MSD6A828	MSD6A828
CPU	Dual-core ARM Cortex-A72 1.8Ghz processor and Quad-core ARM Cortex-A53 1.4Ghz processor	Dual-core ARM Cortex-A72 1.8Ghz processor and Quad-core ARM Cortex-A53 1.4Ghz processor	Dual-core ARM Cortex-A72 1.8Ghz processor and Quad-core ARM Cortex-A53 1.4Ghz processor
GPU	ARM Mali-T860MP4	ARM Mali-T860MP4	ARM Mali-T860MP4
Android Version	Android 7.1	Android 7.1	Android 7.1

<b>RAM</b>	4GB	4GB	4GB
<b>ROM</b>	32GB	32GB	32GB
<b>Speaker Position</b>	Forward	Forward	Forward
<b>Speaker Max.Power Output</b>	16W x 2	16W x 2	16W x 2
<b>Operation Environment</b>	Relative Humidity ≤80% Operation Temperature 0 ~ +40°C above Storage Temperature -10 ~ +60°C	Relative Humidity ≤80% Operation Temperature 0 ~ +40°C above Storage Temperature -10 ~ +60°C	Relative Humidity ≤80% Operation Temperature 0 ~ +40°C above Storage Temperature -10 ~ +60°C

## Physical Specs & Dimensions

<b>Panel Dimension (without wall mount bracket thickness)</b>	59.64 x 4.31 x 36.65 (L * W * H) in 1514.8 x 109.4 x 930.8 (L * W * H) mm	68.70 x 4.20 x 41.87 (L * W * H) in 1745x 106.7 x 1063.5(L * W * H) mm	78.67 x 4.50 x 47.61 (L * W * H) in 1998.3 x 114.3 x 1209.3 (L * W * H) mm
<b>Packing Dimension</b>	65.35 x 9.65 x 41.14 (L * W * H) in 1660 x 245 x 1045 (L * W * H) mm	74.10 x 11.02x 45.67 (L * W * H) in 1880 x 280 x 1160 (L * W * H) mm	84.05 x 11.02 x 52.76 (L * W * H) in 2140 x 280 x 1340 (L * W * H) mm
<b>Net Weight</b>	110 lbs (49.65kg ± 1.5kg) (incl. wall mount)	146 lbs (65.95kg ± 1.5kg) (incl. wall mount)	189 lbs (85.50kg ± 1.5kg) (incl. wall mount)
<b>Gross Weight</b>	140 lbs (63.45Kg ± 1.5kg)	189 lbs (85.70kg ± 1.5kg)	237 lbs (107.3kg ± 1.5kg)
<b>VESA Mount Installation Position</b>	500 x 400mm (4 x M6)	600 x 400mm (4 x M8)	700 x 400mm (4 x M8)

## Connectivity

<b>Front Interface Input Ports</b>	HDMI In x 1, Touch USB-B x 1, USB 3.0 x 1	HDMI In x 1, Touch USB-B x 1, USB 3.0 x 1	HDMI In x 1, Touch USB-B x 1, USB 3.0 x 1
<b>Rear Side Ports</b>	HDMI In x 2, VGA in x1, Touch USB-B x 3, USB2.0 x1, USB3.0x1, Type-C (AV in+Touch)x1, Audio inx1, Mic inx1, MicroSD readerx1, RS-232 jack x1, Audio out x1, SPDIF out x1, Service port x1, Gigabit Lanx1, Antenna port x2	HDMI In x 2, VGA in x1, Touch USB-B x 3, USB2.0 x1, USB3.0x1, Type-C (AV in+Touch)x1, Audio inx1, Mic inx1, MicroSD readerx1, RS-232 jack x1, Audio out x1, SPDIF out x1, Service port x1, Gigabit Lanx1, Antenna port x2	HDMI In x 2, VGA in x1, Touch USB-B x 3, USB2.0 x1, USB3.0x1, Type-C (AV in+Touch)x1, Audio inx1, Mic inx1, MicroSD readerx1, RS-232 jack x1, Audio out x1, SPDIF out x1, Service port x1, Gigabit Lanx1, Antenna port x2
<b>HDMI &amp; HDCP</b>	Licensed	Licensed	Licensed
<b>HDMI In</b>	3	3	3
<b>VGA In</b>	1	1	1
<b>Type-C AV in+ touch</b>	1	1	1
<b>USB-B for touch</b>	4	4	4
<b>PC-Audio In</b>	1	1	1
<b>Mic In</b>	1	1	1
<b>Audio Out</b>	1	1	1
<b>USB 3.0</b>	2	2	2
<b>USB 2.0</b>	1	1	1
<b>SD Reader</b>	1	1	1
<b>SPDIF</b>	1	1	1
<b>RS232</b>	1	1	1
<b>Gigabit LAN RJ45</b>	1	1	1
<b>Mini PC Mount</b>	75x75mm or 100x100mm	75x75mm or 100x100mm	75x75mm or 100x100mm
<b>Wall Mount Bracket</b>	Included	Included	Included
<b>Mounting</b>	VESA 500mmx400mm, 4xM6	VESA 600mmx400mm, 4xM8	VESA 700mmx400mm, 4xM8

## Product Features & Software

Android OS 7.1	✓	✓	✓
Android Annotation	✓	✓	✓
Writing Pen	✓	✓	✓
Screen Share	✓	✓	✓

## Warranty & Service

Warranty	5 years	5 years	5 years
Onsite Service	✓	✓	✓



## AVer Information Inc. Americas

[averusa.com](http://averusa.com)

668 Mission Court,  
Fremont, CA 94539

T 408.263.3828

F 408.263.8132

Toll Free 1.877.528.7824